

KLINIC DOORS **SWING** model



The KLINIC swing door meets high standards of health and hygiene, is versatile enough to be used in existing gaps, and is consequently very often used both in renovations and in new build. KLINIC swing doors are used in sectors with strict sanitation or hygiene requirements, including: Hospitals, the pharmaceutical industry, food handling, the chemical industry, healthcare centres and industrial kitchens.

The operators of KLINIC swing doors are equipped with Evolution System automatic door technology, guaranteeing perfect movement of the doors. The Evolution system also enables two versions to be used;

- **Evolution B3:** electromechanical operator with motor opening and closure.
- **Evolution B1:** incorporates a spring system which enables it to operate semi-automatically (motor opening / spring closure).

The leaves are manufactured under strict quality control measures and the high quality of the materials used ensures that it operates in accordance with the highest levels of compliance in terms of hygiene and sanitation standards;

- **A 70 mm thick panel**, in AISI 304 stainless steel (AISI 316 to order) with a natural vegetable fibre core.
- **Rubber weather strip** for the seal.
- **Sub-frame;** AISI 304 stainless steel frame system (AISI 316 to order) to cover the whole of the internal gap in the door.
- **Viewer;** with the option of supplying the door with different types of spyholes; round, square, rectangular and triangular.
- **Handle;** positioned on the inside and outside, made from stainless steel.



SWING FRAME

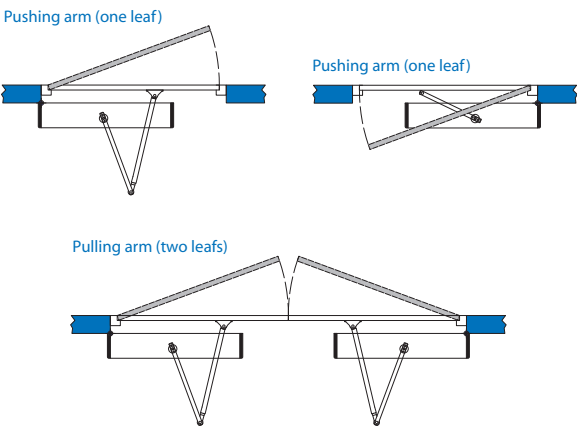
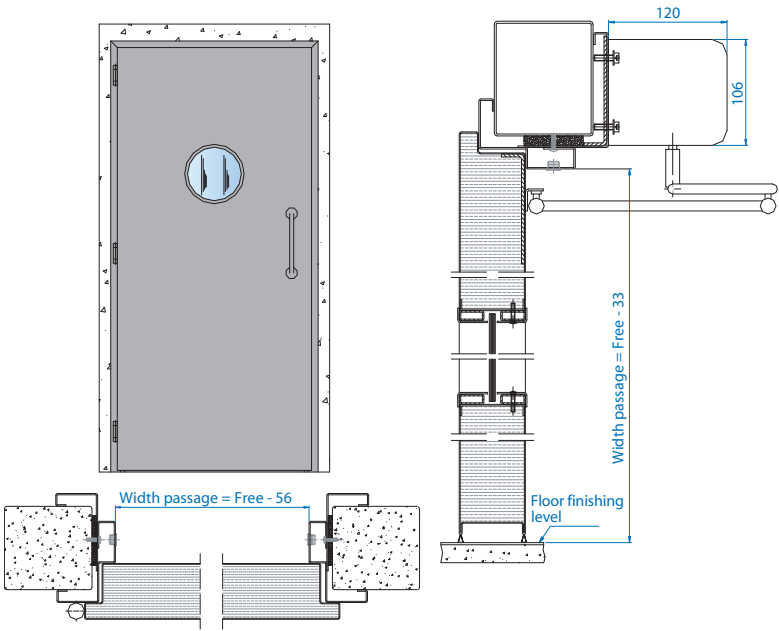

- ✓ **QUALITY AND ROBUSTNESS**
- ✓ **SANITATION AND HYGIENE**
- ✓ **SMOOTH & SILENT MOVEMENT**
- ✓ **DIFFERENT TYPES OF FINISH**
- ✓ **WIDE RANGE OF ACCESSORIES**

TECHNICAL SPECIFICATIONS

OPERADOR	EVOLUTION
Dimensions	106 h x 550 w x 120 d
Power supply	230 vac (+/- 10%)
Max. consumption of accessories	20 w
Maximum weight of door	250 kg
Maximum width of door	1400 mm
Maximum angle of opening	95°
IP rating	IP22
Temperature range	-20° / +50°
Push & Go	optional

DEVICES

DIGITAL SELECTOR	DETECTORS	SAFETY
Selection of operating modes	Infrared sensors	Safety sensors
Adjustment, operating parameters	Proximity detectors	Photocells
Activation and deactivation of options	Elbow activated button	
Diagnosis of faults and error modes	Magnetic card	
Code selector	Numerical code	