

AVISO

Esta guía rápida es un resumen del manual de instalación completo. Dicho manual contiene advertencias de seguridad y otras explicaciones que deben ser tenidas en cuenta. Puede descargar el manual de instalación en el apartado "Descargas" de la web de Erreka:
<http://www.erreka-automation.com>

Elementos de la instalación completa

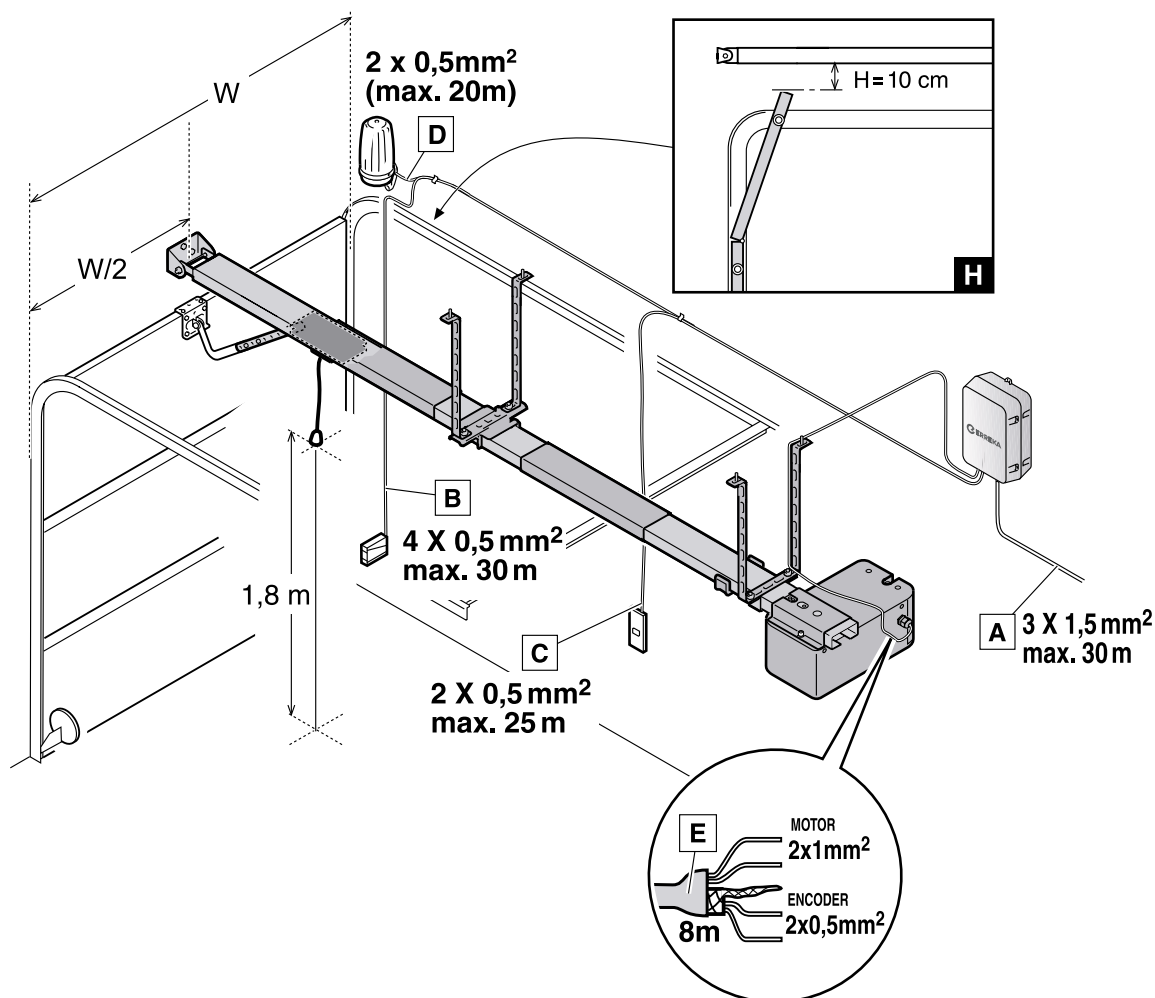

I277B

Cableado eléctrico

- A: Alimentación general
- B: Fotocélulas de cierre
- C: Pulsador / llave de pared
- D: Lámpara destellante LUMI
- E: Accionador (motor + encoder)

Cotas de montaje

Cota H: el carril debe quedar 10 cm por encima del punto más alto de la puerta (ver detalle **H**).

Longitud total (accionador + guía) / carrera útil:

- carril ref. AMX01: 3.380mm / 2.788mm
- carril ref. AMX02: 4.480mm / 3.888mm

Desbloqueo y bloqueo

Desbloqueo

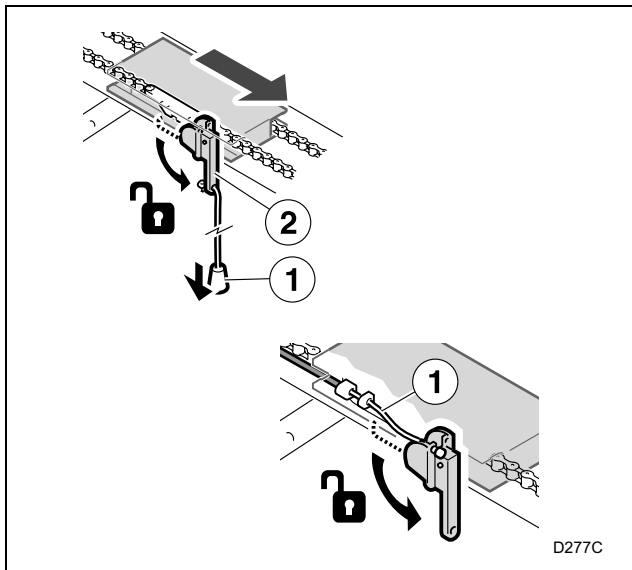

Desbloqueo para accionamiento manual

Tire del pomo o cable (1) hasta que la palanca de desbloqueo (2) quede vertical.

Bloqueo

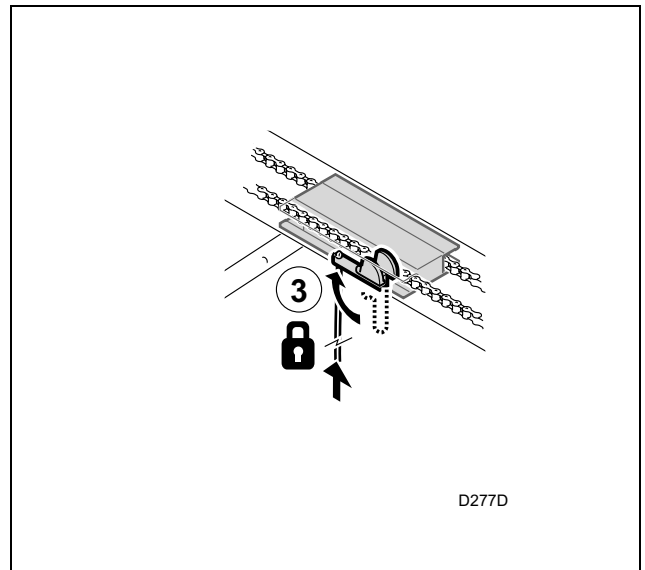

Bloqueo para accionamiento motorizado

Coloque la palanca en posición horizontal (3). El bloqueo se realizará cuando funcione el accionador.

Montaje

- 1** Fije el carril (1) en el accionador (2).

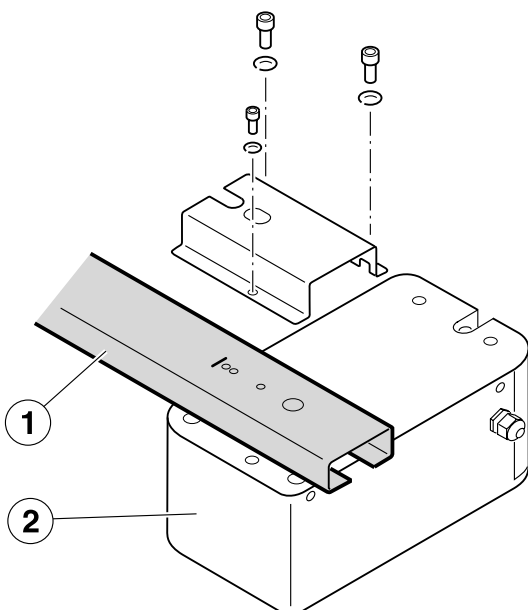

- 2** Coloque las pletinas de techo (3) y el soporte delantero (4). Tenga en cuenta la cota de montaje H (vea "cotas de montaje" en la página anterior).

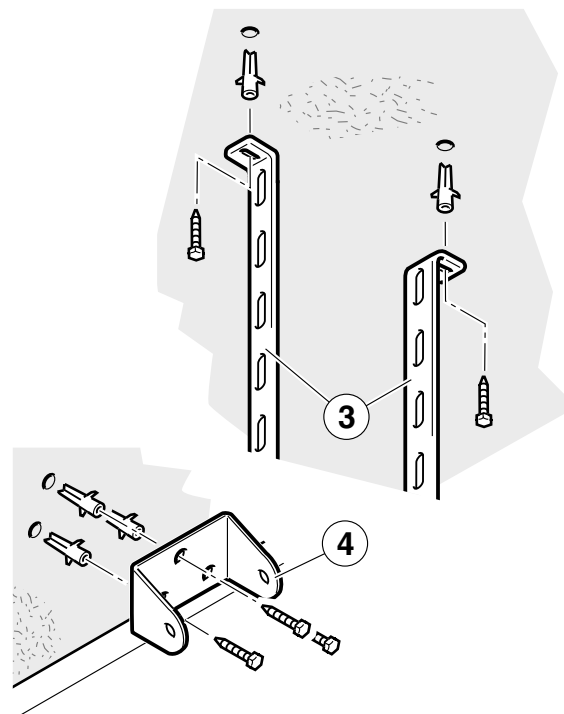

3 Coloque el conjunto carril (1) + accionador (2) en los soportes (3) y (4).

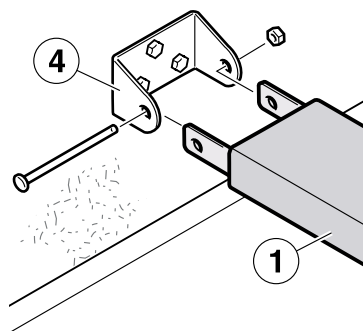

❶ El carril (1) debe quedar horizontal.

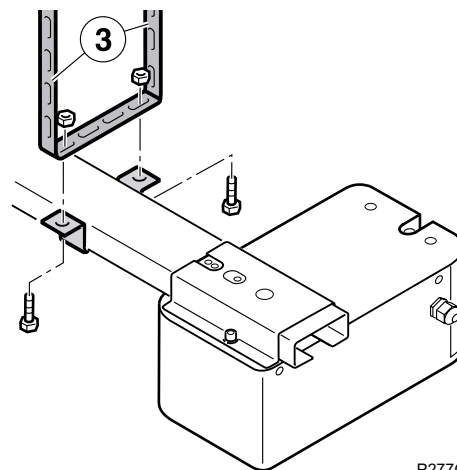
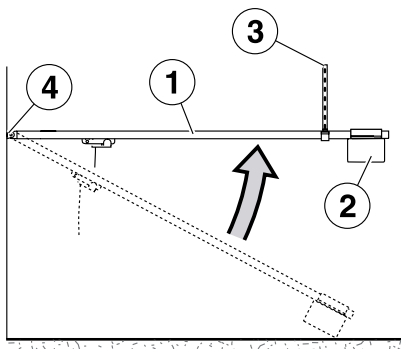

P277C

4 Coloque el anclaje (5) en la parte superior de la puerta y mediante los brazos (6) y (7), engánchelo al carro (8).

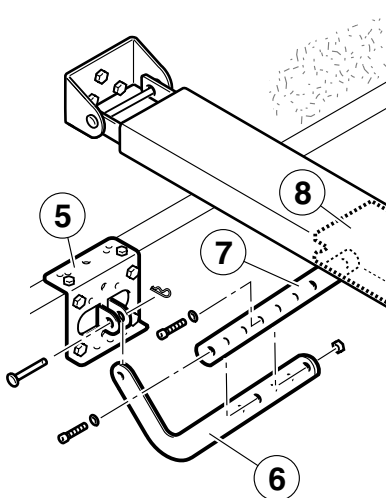
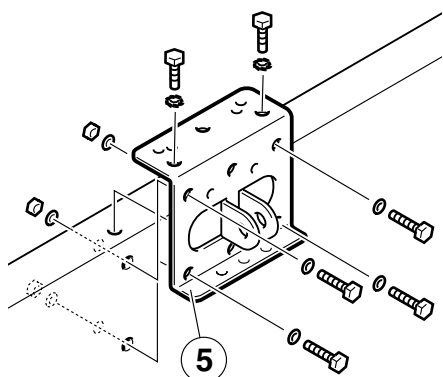

P260D

5 Tense la cadena: apriete la tuerca hasta que haga tope, y después, afloje ligeramente hasta que el casquillo pueda girarse con la mano.

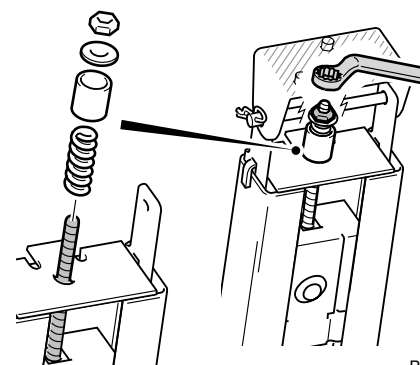

P260E

6 Instale el soporte central (9).

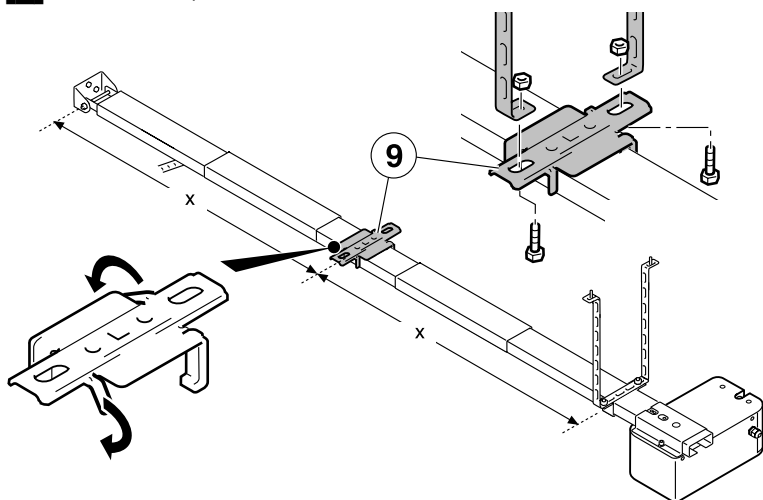

P277F

7 Abra la puerta e instale el tope de apertura (10), haciendo tope con el carro (11). Utilice dos tornillos autotaladrantes y autorroscantes.

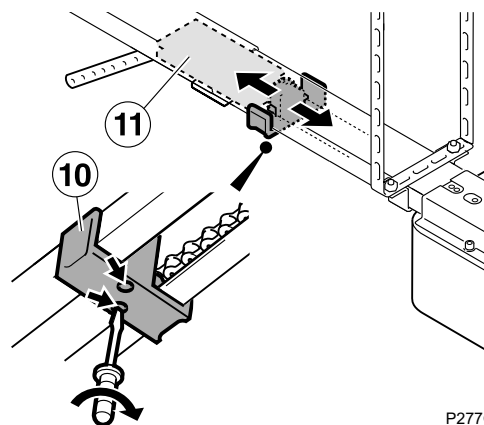

P277G

Conexiones eléctricas (cuadro VIVO-D102)

⚠ Desconecte la alimentación eléctrica antes de conectar o desconectar cualquier componente.

🔌 Los dispositivos A.T., SG.C y SG.A deben estar libres de potencial, para evitar daños en el cuadro de maniobra.

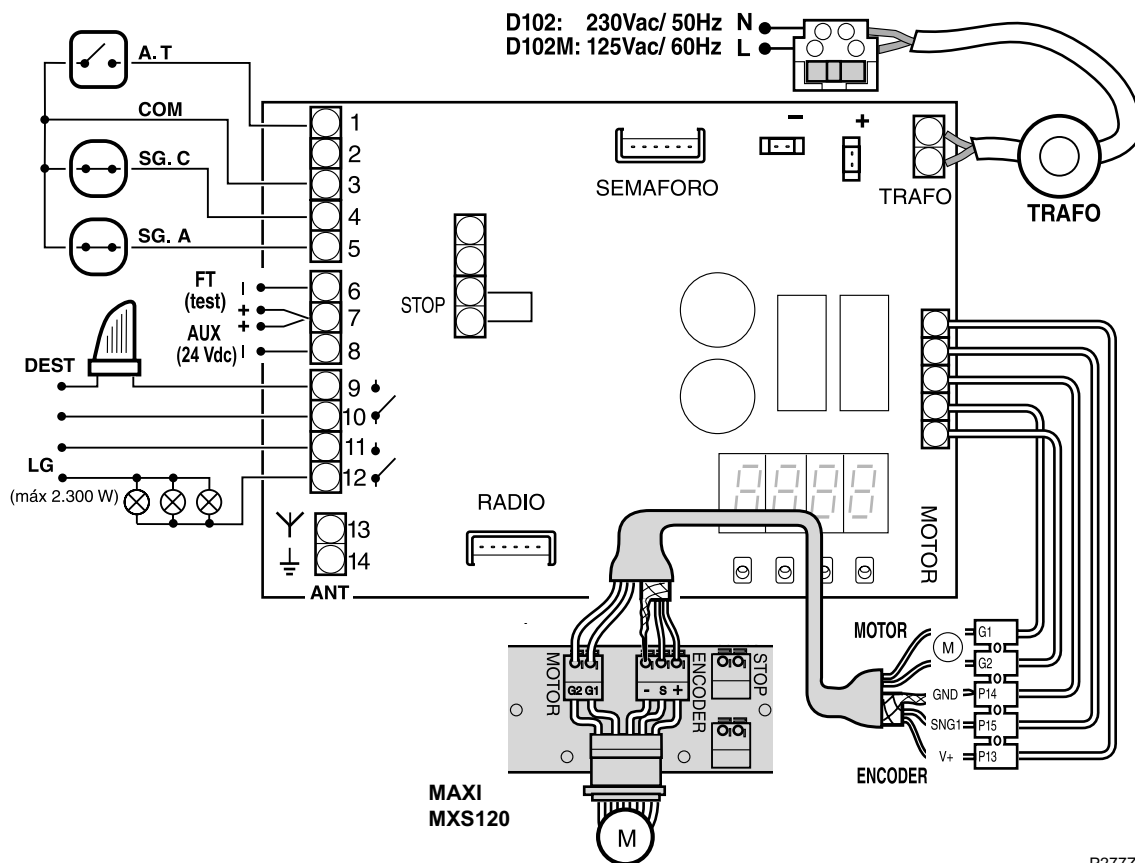

P277Z

- A.T. Pulsador o llave de pared
- SG.C Dispositivo de seguridad en cierre (fotocélula de cierre)
- SG.A Dispositivo de seguridad en apertura (fotocélula de apertura)
- FT Conexión para fotocélulas con testeo
- AUX Alimentación de periféricos (24 Vdc)
- STOP No se usa, realizar un puente eléctrico
- DEST Lámpara destellante (LUMI)
- LG Luces de garage

- G1 Azul (motor)
- G2 Rojo (motor)
- P14 (GND) Malla (masa encoder) (-)
- P15 (SNG1) Verde (señal encoder) (S)
- P13 (V+) Marrón (alimentación encoder) (+)

AVERTISSEMENT

Ce guide rapide est un résumé du manuel d'installation complet. Cette notice contient des avertissements de sécurité et d'autres explications qui doivent être pris en compte. Vous pouvez télécharger le manuel d'installation dans la section « Téléchargements » du site web d'Erreka : <http://www.erreka-automation.com>

Éléments de l'installation complète

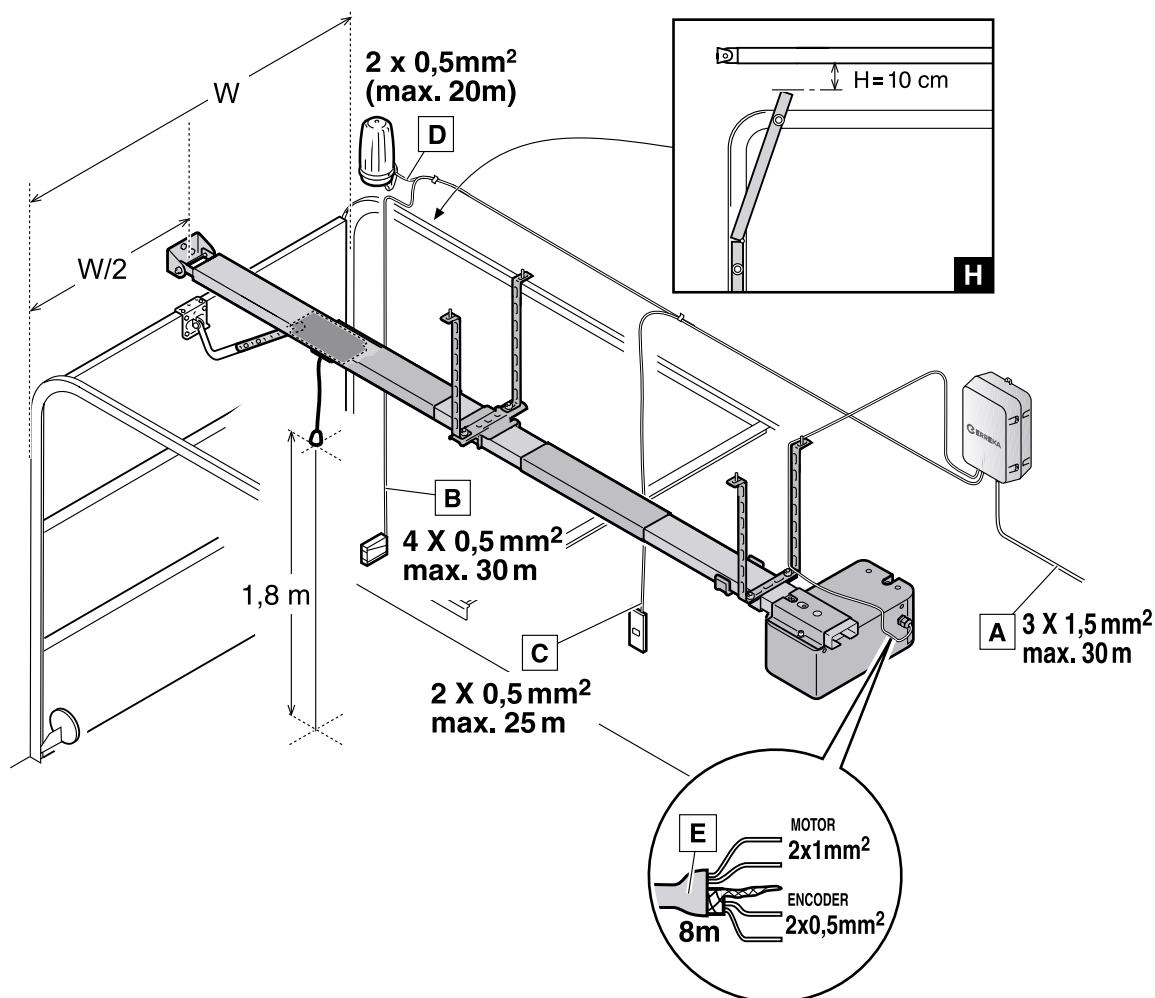

I277B

Câblage électrique

- A : Alimentation générale
- B : Photocellules de fermeture
- C : Bouton-poussoir/clef de mur
- D : Feu clignotant LUMI
- E : Actionneur (moteur + encodeur)

Cotes de montage

Cote H : le rail doit rester à 10 cm au-dessus du point le plus haut du portail (voir détail **H**).

Longueur totale (actionneur + guide) / course utile :

- rail réf. AMX01 : 3.380mm / 2.788mm
- rail réf. AMX02 : 4.480mm / 3.888mm

Débloccage et blocage

Débloccage

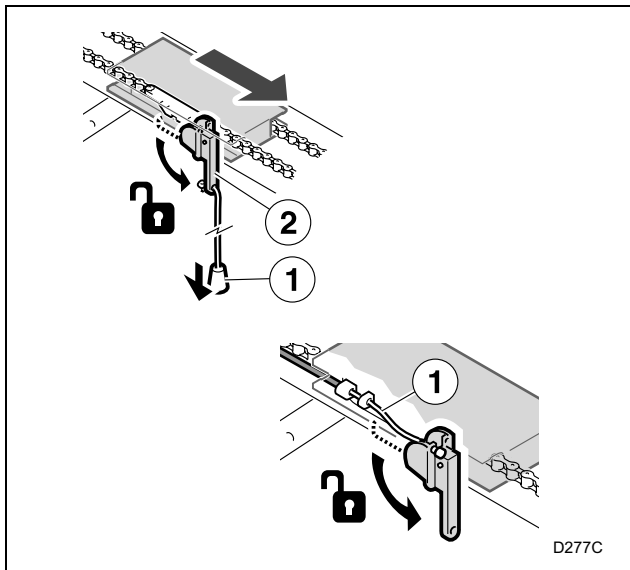

Débloccage pour un actionnement manuel

Tirez la poignée ou le câble (1) jusqu'à ce que le levier de déblocage (2) reste vertical.

Blocage

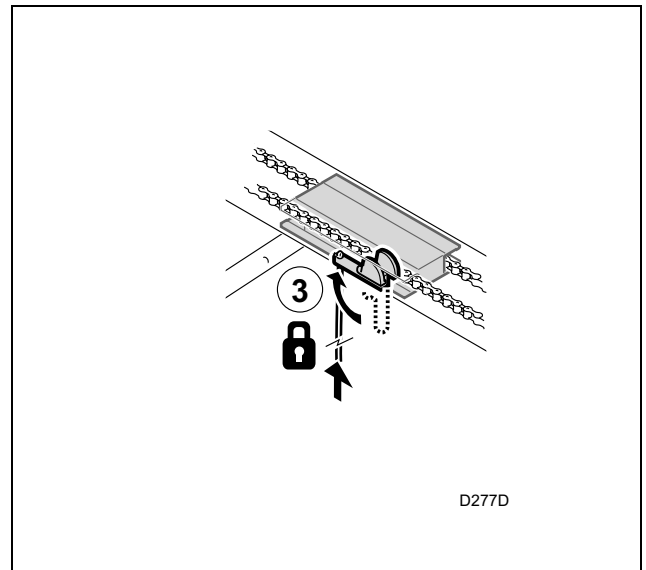

Blocage pour actionnement motorisé

Placez le levier sur la position horizontale (3). Le blocage sera réalisé lorsque l'actionneur se mettra en marche.

Montage

- 1 Fixer le rail (1) sur l'actionneur (2).

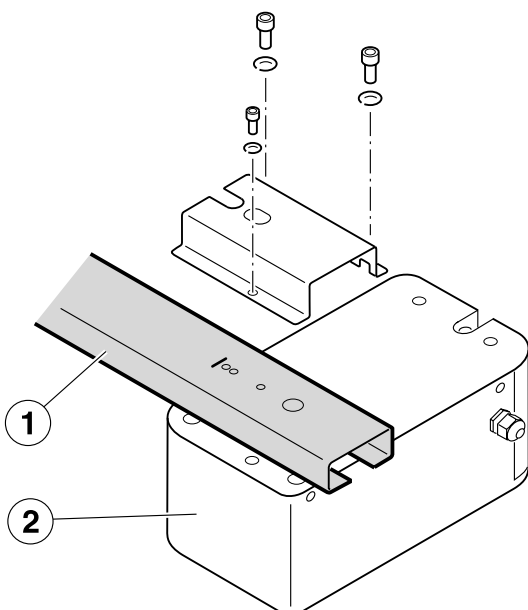

- 2 Placer les platines de plafond (3) et le support avant (4). Tenir compte de la cote de montage H (consulter "cotes de montage" sur la page précédente).

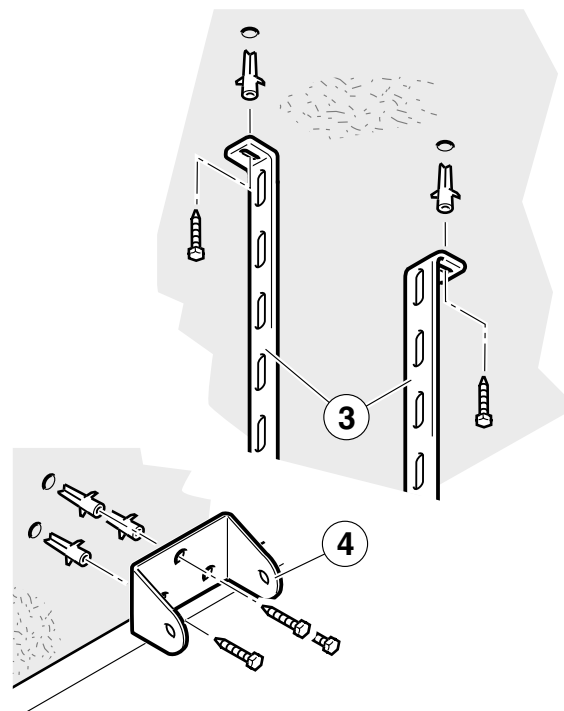

3 Placer l'ensemble rail (1) + actionneur (2) sur les supports (3) et (4).

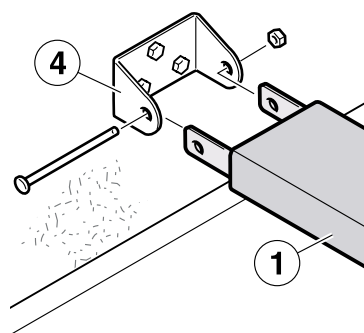

❶ Le rail (1) doit être horizontal.

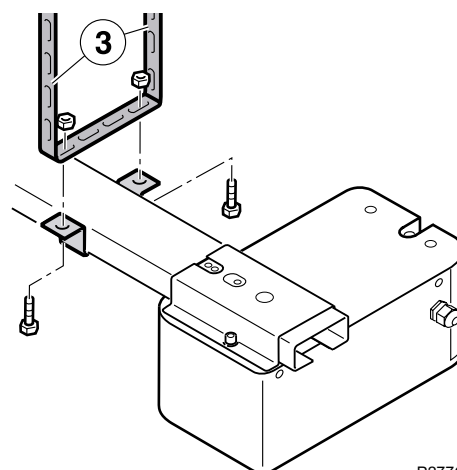
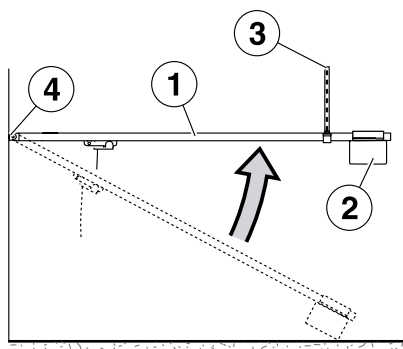

P277C

4 Placer l'ancrage (5) sur la partie supérieure du portail et avec les bras (6) et (7) et le fixer au chariot (8).

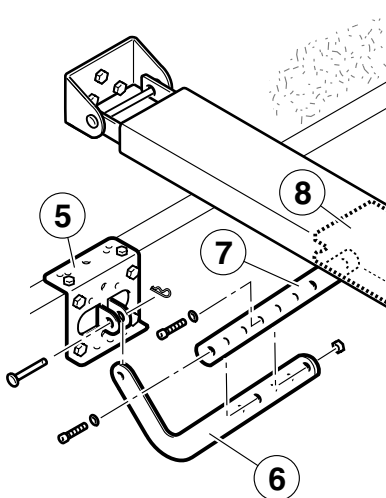
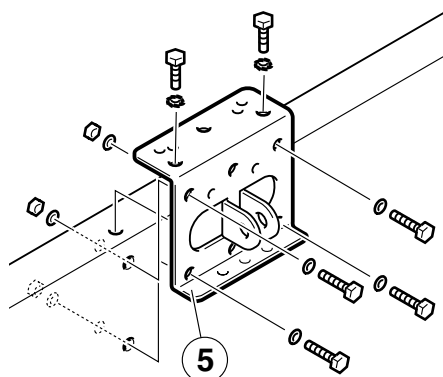

P260D

5 Tendre la chaîne en serrant l'écrou jusqu'à atteindre la butée, puis ensuite la desserrer légèrement jusqu'à ce que la douille puisse être tournée manuellement.

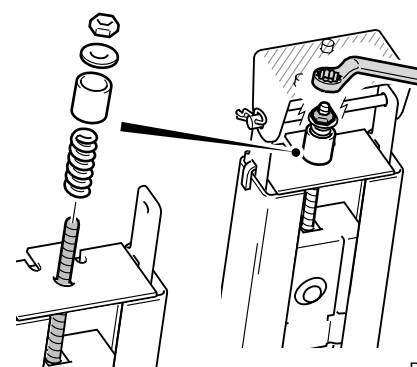

P260E

6 Installer le support central (9).

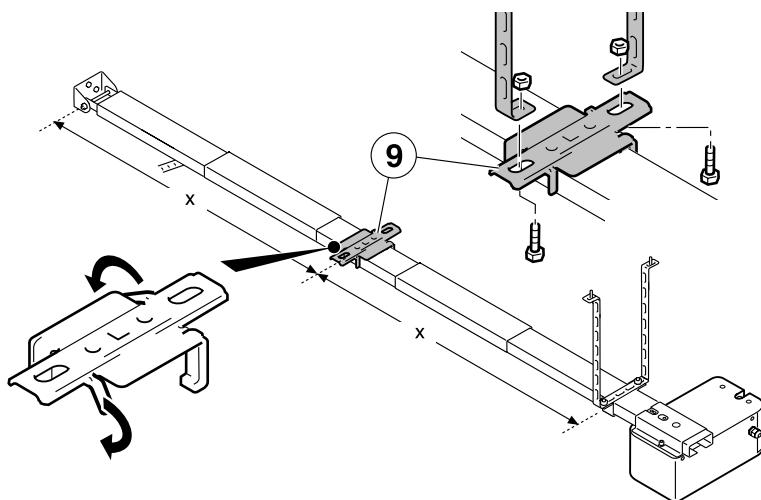

P277F

7 Ouvrez le portail et installez la butée d'ouverture (10) une fois en contact avec le chariot (11). Utiliser deux vis auto-perceuses et auto-taraudeuses.

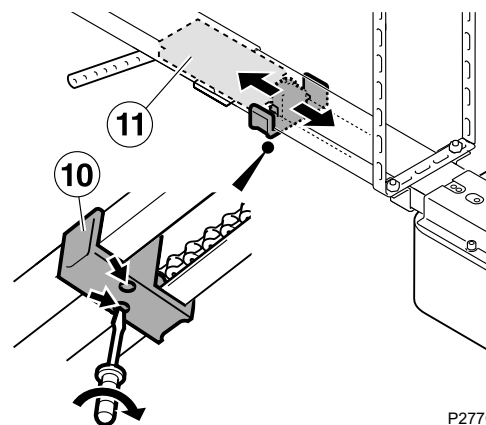

P277G

Connexions électriques (armoire VIVO-D102)

⚠ Déconnectez l'alimentation électrique avant de connecter ou de déconnecter un composant quelconque.

Les dispositifs A.T., SG.C et SG.A doivent être libres de potentiel pour éviter des dommages dans l'armoire de commande.

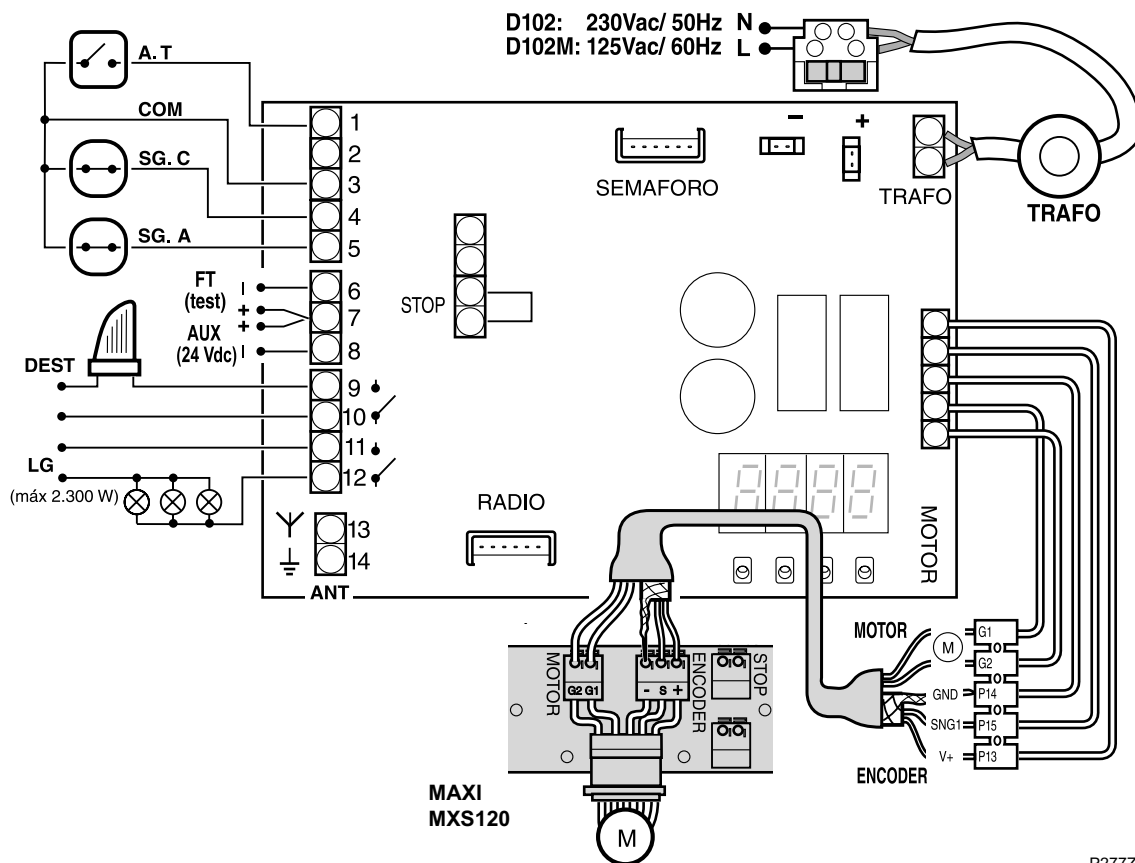

P277Z

- A.T. Bouton-poussoir ou clé de mur
- SG.C Dispositif de sécurité en fermeture (photocellule de fermeture)
- SG.A Dispositif de sécurité en ouverture (photocellule d'ouverture)
- FT Connexion pour photocellules avec test
- AUX Alimentation de périphériques (24 Vdc)
- STOP Non utilisé, effectuer un pont électrique
- DEST Feu clignotant (LUMI)
- LG Éclairage de garage

- G1 Bleu (moteur)
- G2 Rouge (moteur)
- P14 (GND) Maille (masse encodeur) (-)
- P15 (SNG1) Vert (signal encodeur) (S)
- P13 (V+) Marron (alimentation encodeur) (+)

WARNING

This quick guide is a summary of the complete installation manual. The manual contains safety warnings and other explanations which must be taken into account. The installation manual can be downloaded by going to the "Downloads" section of Erreka website: <http://www.erreka-automation.com>

Elements of the complete installation

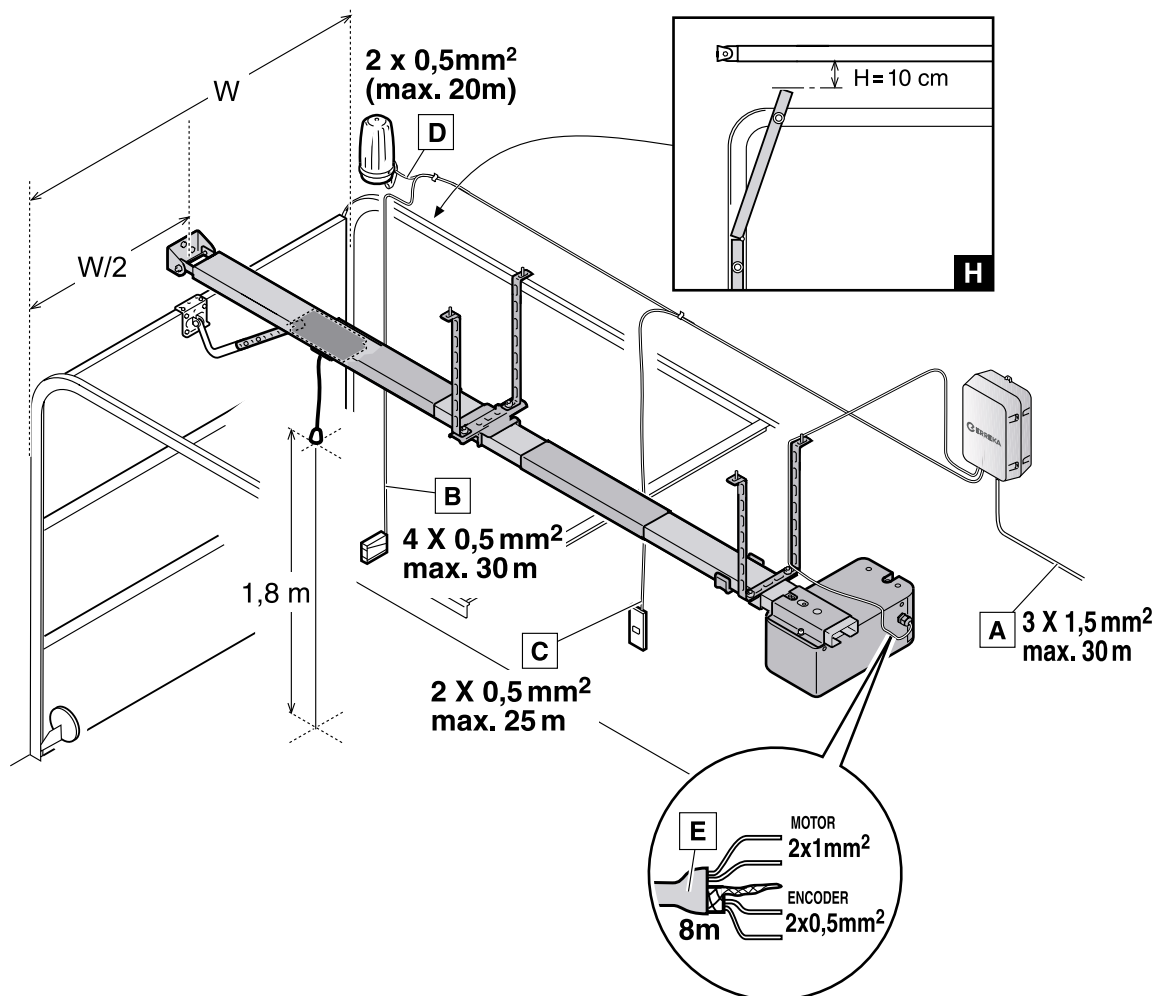

I277B

Electrical wiring

- A: Main power supply
- B: Closing photocells
- C: Pushbutton / wall key
- D: LUMI flashing light
- E: Operator (motor / encoder)

Assembly levels

Level H: the track should remain 10 cm above the highest point of the door (see detail **H**).

Total length (operator + guide) / working stroke:

- track ref. AMX01: 3,380mm / 2,788mm
- track ref. AMX02: 4,480mm / 3,888mm

Unlocking and locking

Unlocking

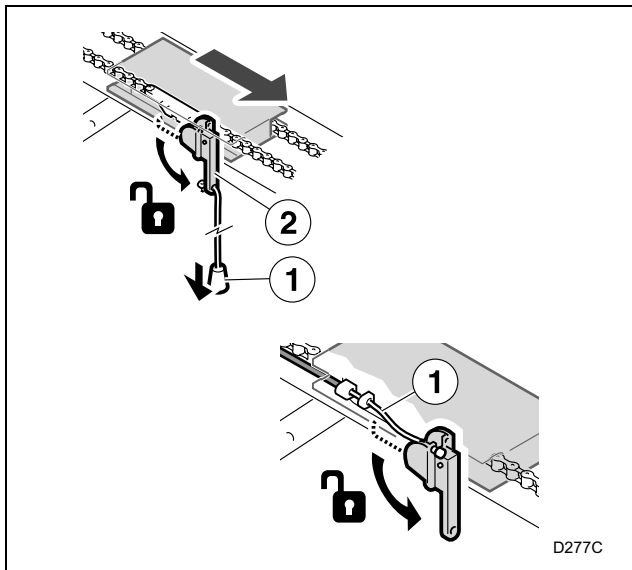

Unlocking for manual operation

Pull the knob or cable (1) until the release lever (2) is vertical.

Locking

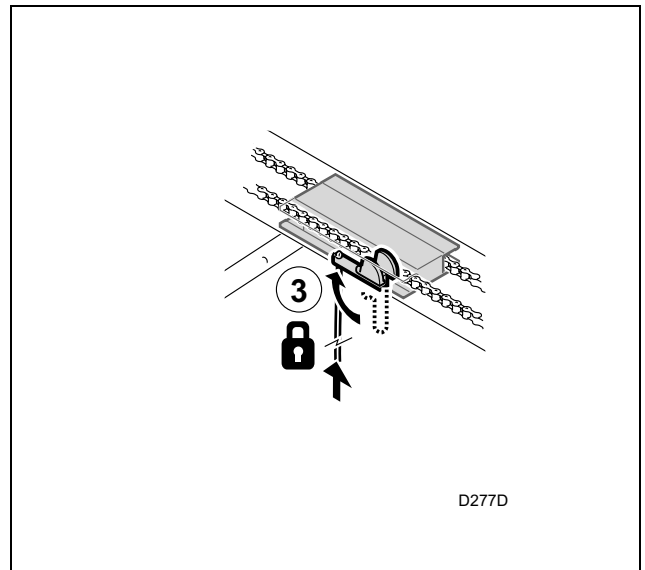

Motorised operation locking

Place the lever in horizontal position (3). Locking will take place when the operator starts up.

Assembly

- 1 Secure the track (1) in the operator (2).

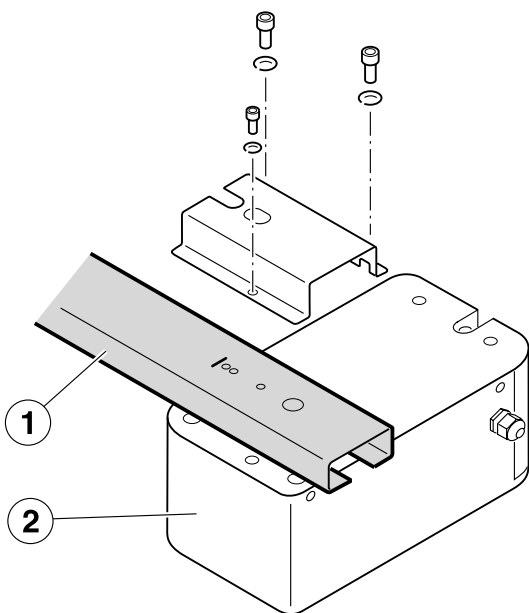

- 2 Position the overhead strips (3) and front support (4). Bear in mind assembly level H (see "assembly levels" on the previous page).

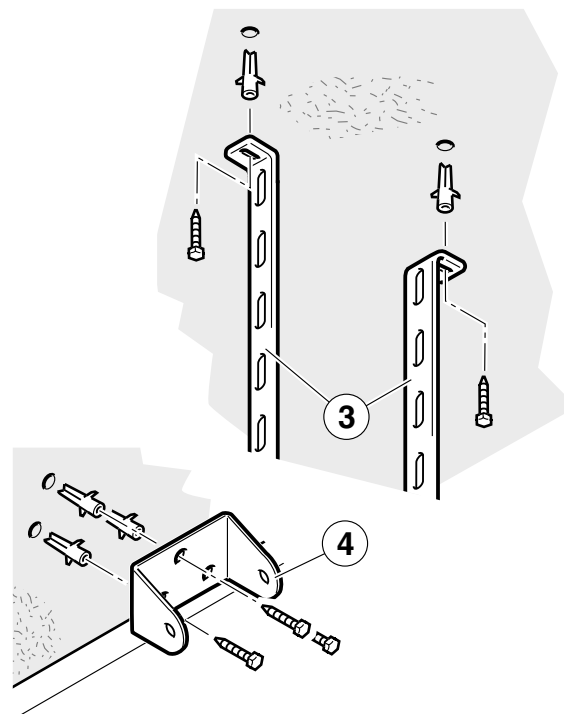

3 Mount the track (1) + operator (2) on the supports (3) and (4).

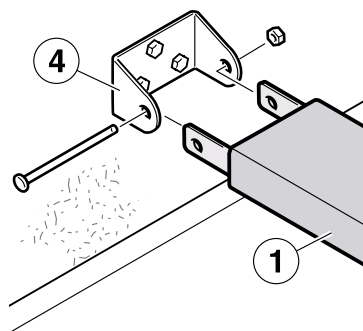

⚠ The track (1) must be horizontal.

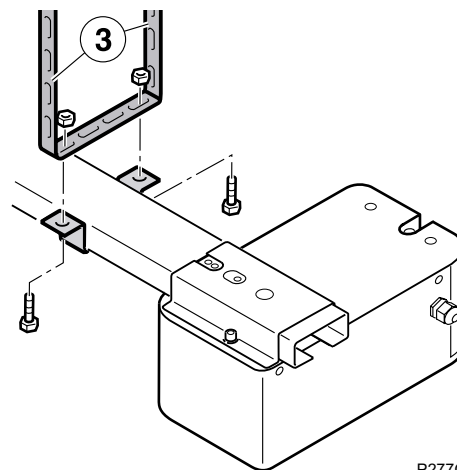
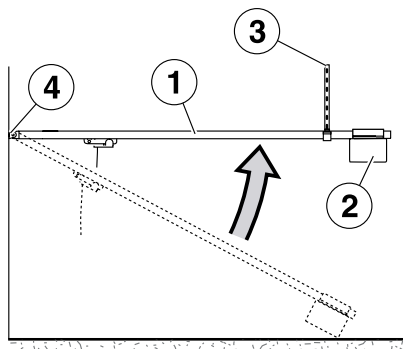

P277C

4 Position the anchoring (5) in the upper part of the door using the arms (6) and (7), and couple it to the carriage (8).

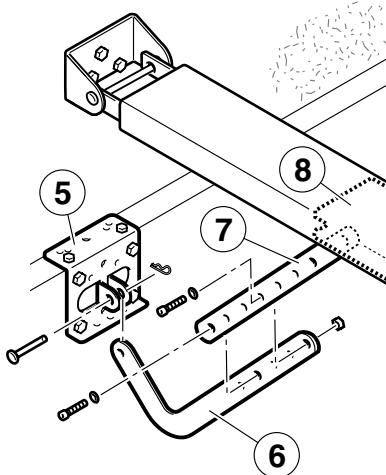
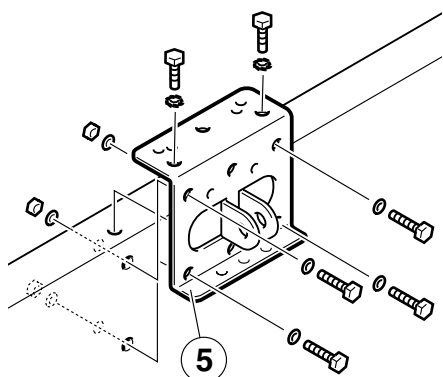

P260D

5 Tighten the nut as far as possible, and then loosen it slightly until the sleeve can be turned by hand.

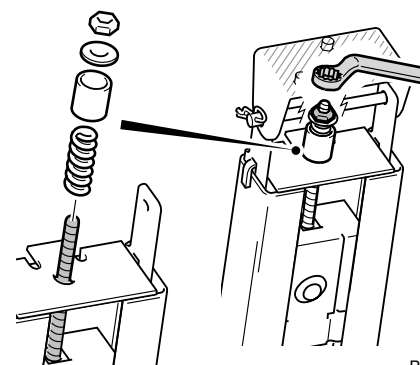

P260E

6 Install the central mount (9).

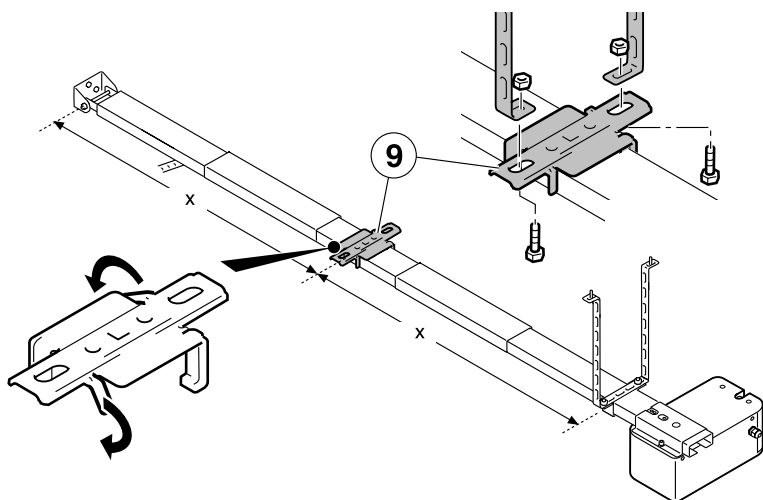

P277F

7 Open the door and install the opening stopper (10) until it comes up against the carriage (11). Use two self-drilling, self-tapping screws.

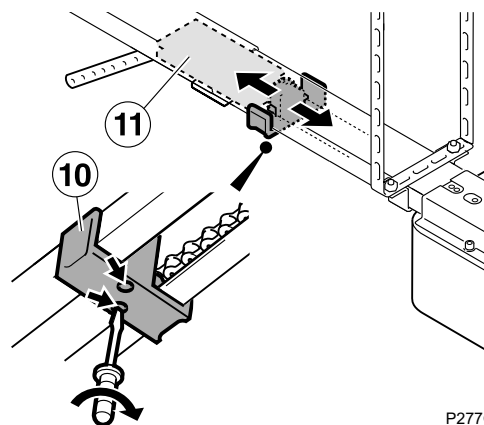

P277G

Electrical connections (panel VIVO-D102)

⚠ Disconnect the power supply before connecting or disconnecting any component.

🔌 The A.T., S and STOP devices must be voltage-free in order to prevent any damage to the control board.

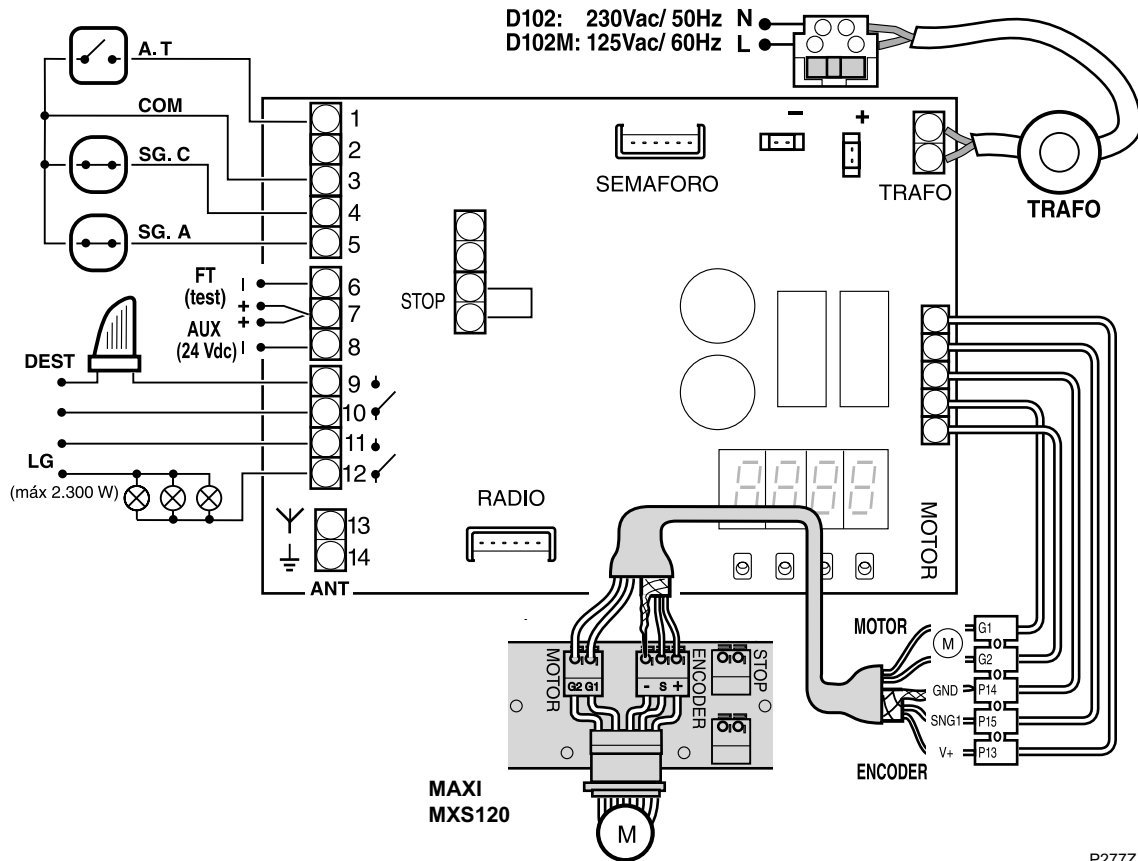

P277Z

- A.T. Wall key or pushbutton
- SG.C Closing safety device (closing photocell:)
- SG.A Opening safety device (opening photocell:)
- FT Connection for photocells with testing
- AUX Power supply for peripherals (24 Vdc)
- STOP Not used, perform bridging
- DEST Flashing light (LUMI)
- LG Garage lights

- G1 Blue (motor)
- G2 Red (motor)
- P14 (GND) Mesh (encoder mesh) (-)
- P15 (SNG1) Green (encoder signal) (S)
- P13 (V+) Brown (encoder power supply) (+)

AVISO

Este guia rápido é um resumo do manual de instalação completo. Este manual contém advertências de segurança e outras explicações a ter em atenção. Pode transferir o manual de instalação na secção "Downloads" do site da Erreka:
<http://www.erreka-automation.com>

Elementos da instalação completa

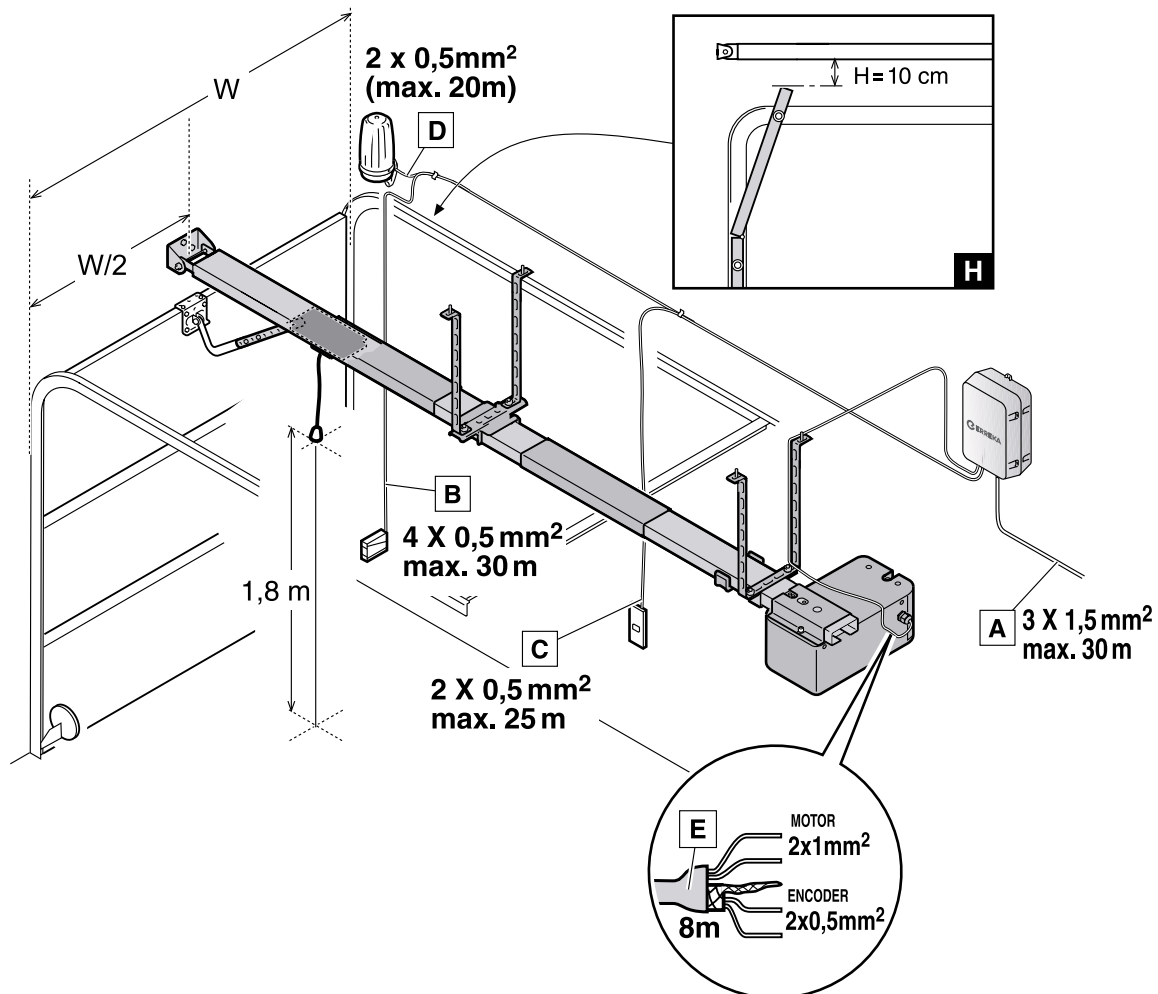

I277B

Cablagem eléctrica

- A: Alimentação geral
- B: Fotocélulas de fecho
- C: Botão de pressão/chave de parede
- D: Lâmpada de sinalização LUMI
- E: Accionador (motor + encoder)

Cotas de montagem

Cota H: a calha deve ficar 10 cm acima do ponto mais alto da porta (ver detalhe **H**).

Comprimento total (accionador + guia)/curso útil:

- calha ref. AMX01: 3.380 mm/2.788 mm
- calha ref. AMX02: 4.480 mm/3.888 mm

Desbloqueio e bloqueio

Desbloqueio

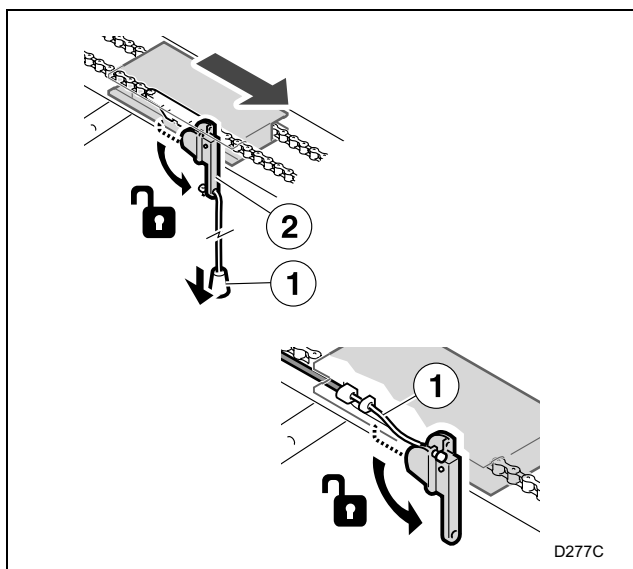

Desbloqueio para accionamento manual

Puxe o puxador ou cabo (1) até a alavanca de desbloqueio (2) ficar na vertical.

Bloqueio

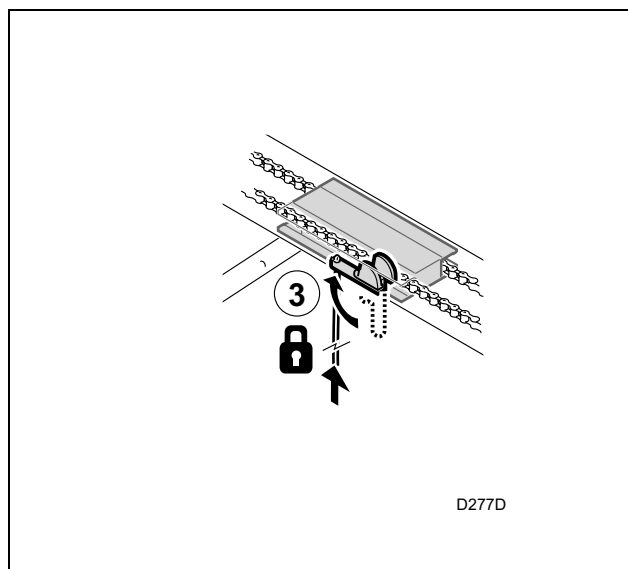

Bloqueio para accionamento motorizado

Coloque a alavanca na posição horizontal (3). O bloqueio será efectuado quando o accionador funcionar.

Montagem

1 Fixe a calha (1) no accionador (2).

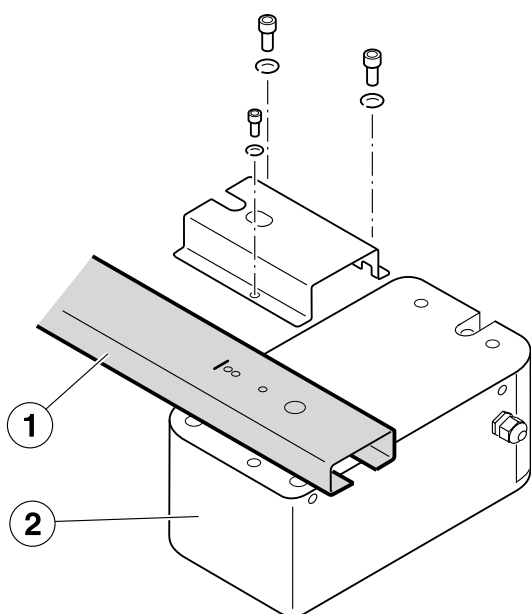

2 Coloque as barras de sustentação no tecto (3) e o suporte dianteiro (4). Tenha em atenção a cota de montagem H (ver "cotas de montagem" na página anterior).

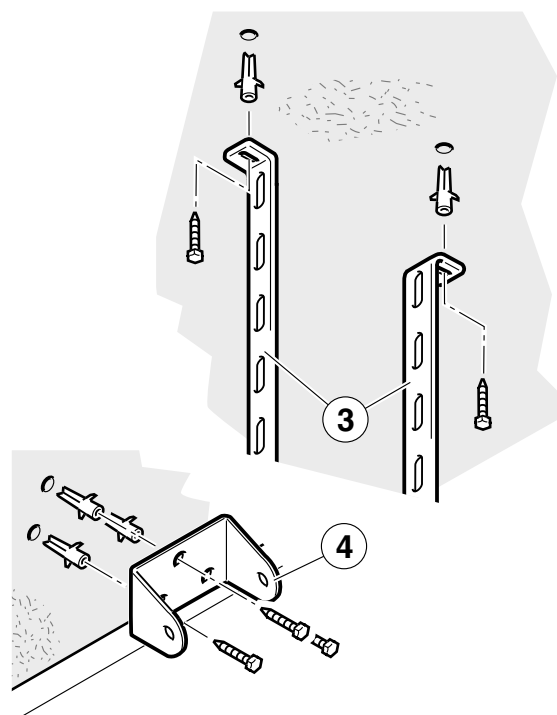

3 Coloque o conjunto da calha (1) + accionador (2) nos suportes (3) e (4).

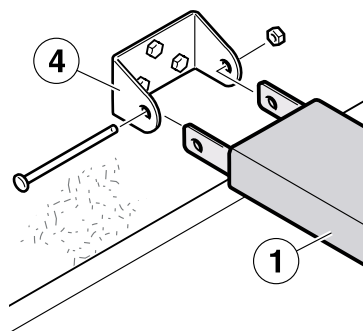

❶ A calha (4) deve ficar na horizontal.

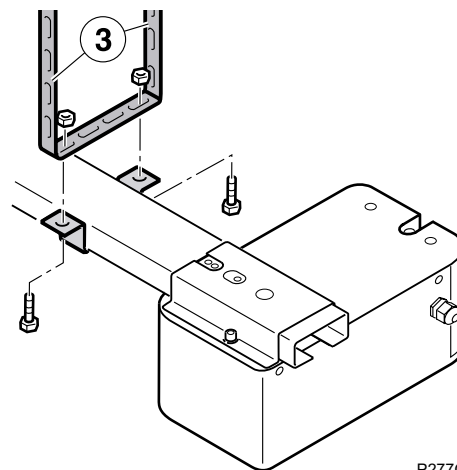
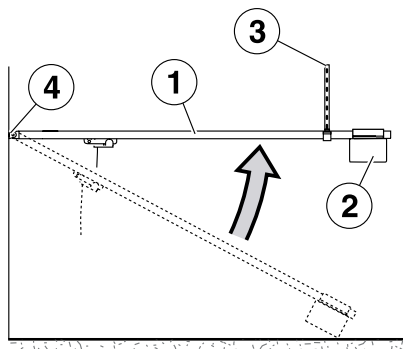

P277C

4 Coloque a ancoragem (5) na parte superior da porta e, através dos braços (6) e (7), engate-a no carro (8).

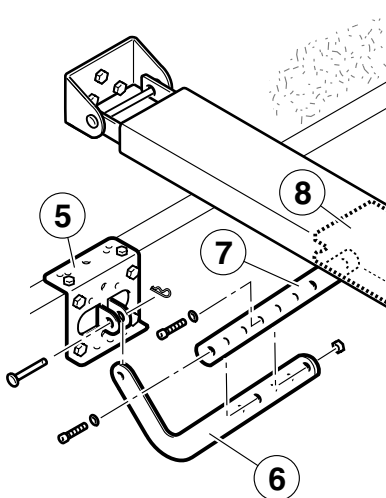
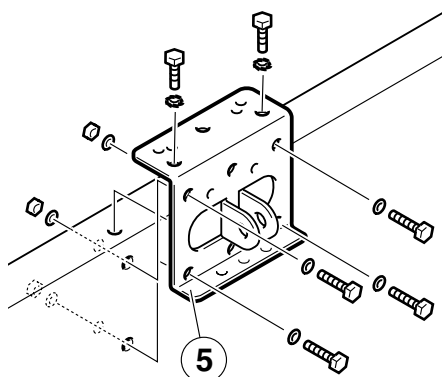

P260D

5 Estique a correia: aperte a porca até ao batente e depois desaperte ligeiramente até que seja possível girar o casquilho com a mão.

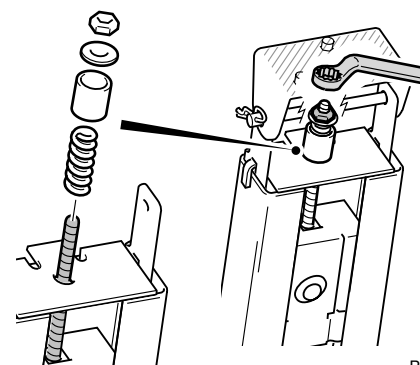

P260E

6 Instale o suporte central (9).

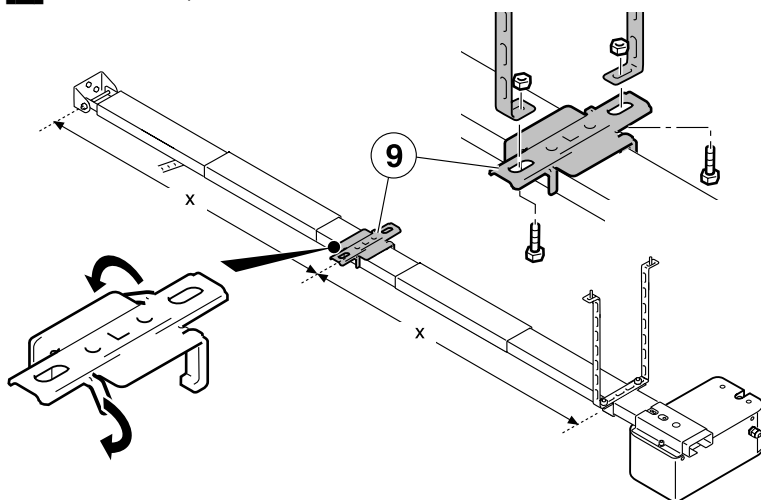

P277F

7 Abra a porta e instale o batente de abertura (10), até ao limite com o carro. Utilize dois parafusos auto-perfuradores e auto-roscentes.

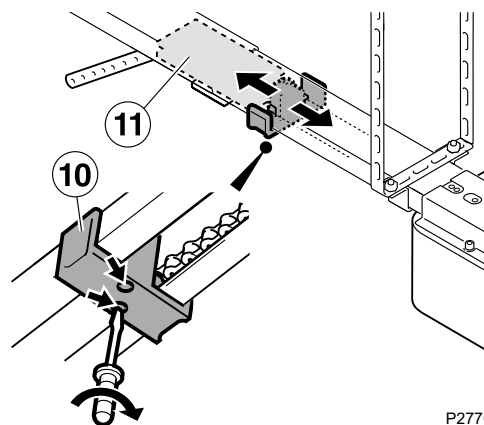

P277G

Ligações eléctricas (quadro VIVO-D102)

⚠ Desligue a alimentação eléctrica antes de ligar ou desligar qualquer componente.

🔌 Os dispositivos A.T., SG.C e SG.A devem estar livres de potencial para evitar danos no quadro de manobra.

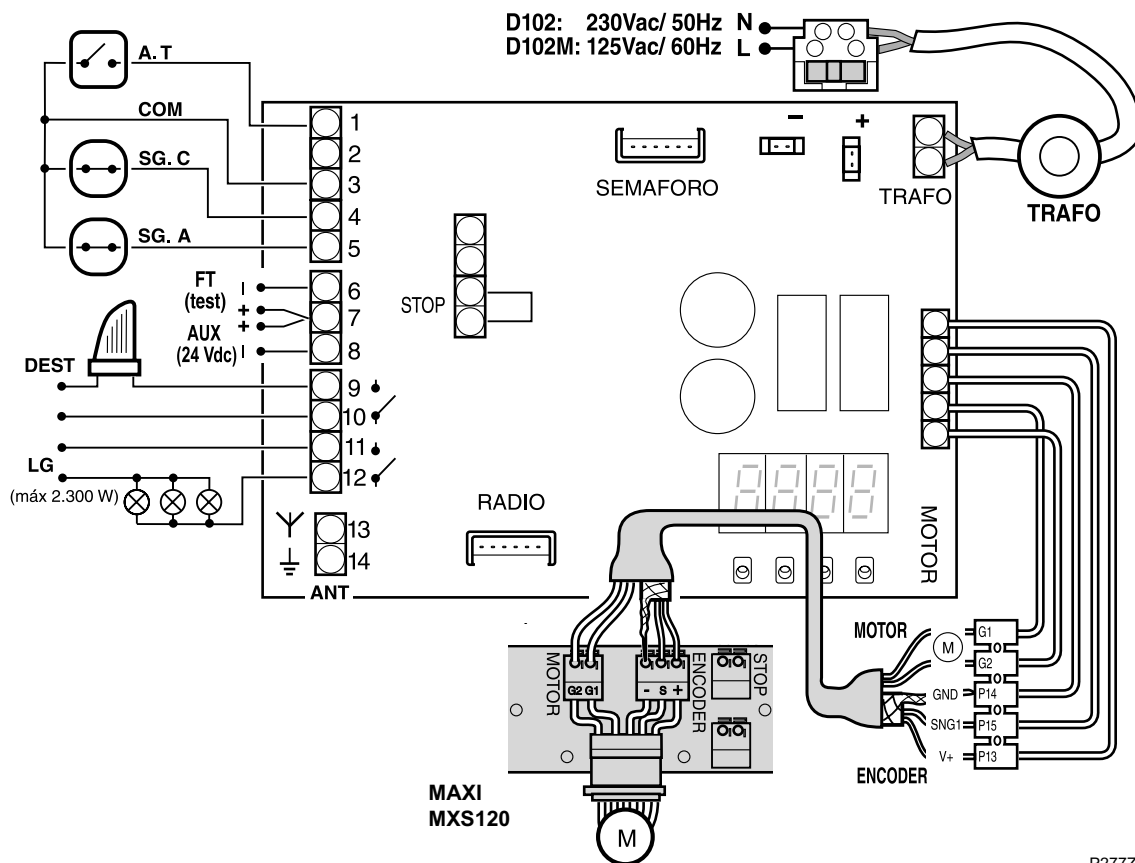

P277Z

| | |
|------|---|
| A.T. | Botão ou chave de parede |
| SG.C | Dispositivo de segurança no fecho (fotocélulas de fecho) |
| SG.A | Dispositivo de segurança no fecho (fotocélulas de abertura) |
| FT | Conexão para fotocélulas com teste |
| AUX | Alimentação de periféricos (24 Vdc) |
| STOP | Não utilizado, realizar uma ponte eléctrica |
| DEST | Lâmpada de sinalização (LUMI) |
| LG | Luzes de garagem |

| | |
|------------|------------------------------------|
| G1 | Azul (motor) |
| G2 | Vermelho (motor) |
| P14 (GND) | Malha (massa encoder) (-) |
| P15 (SNG1) | Verde (sinal encoder) (S) |
| P13 (V+) | Castanho (alimentação encoder) (+) |

HINWEIS

Dieser Kurzführer ist eine Zusammenfassung der kompletten Montageanleitung. Diese enthält Sicherheitshinweise und andere Erläuterungen, die beachtet werden müssen. Die Montageanleitung kann auf der Erreka-Website unter „Downloads“ heruntergeladen werden:
<http://www.erreka-automation.com>

Elemente der kompletten Anlage

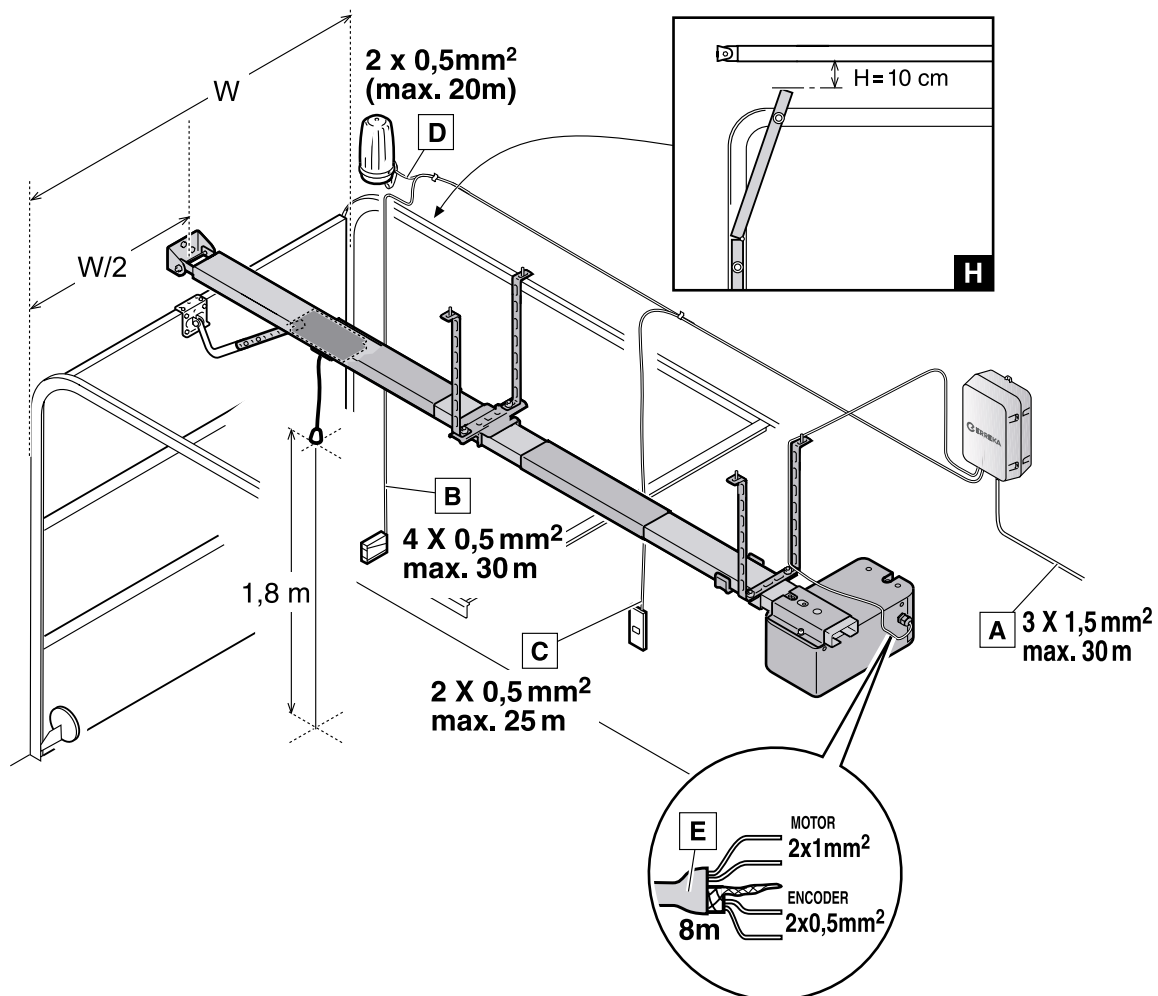

I277B

Stromkabel

- A: Hauptstromversorgung
- B: Lichtschranke Schließen
- C: Drucktaster/ Schlüsseltaster
- D: Blinklampe LUMI
- E: Antrieb (Motor + Encoder)

Montagemaße

Maß H: Die Schiene muss sich 10 cm über dem höchsten Punkt des Tors befinden (siehe Detailansicht **H**).

Gesamtlänge (Antrieb + Führung) / Nutzhub :

- Schiene Ref. AMX01: 3.380mm / 2.788mm
- Schiene Ref. AMX02: 4.480mm / 3.888mm

Ent- und Verriegelung

Entriegelung

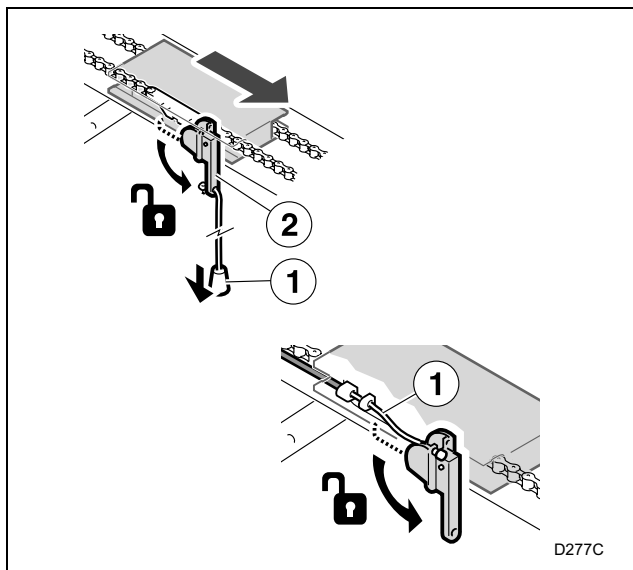

Entriegelung für manuelle Betätigung

Ziehen Sie am Knauf oder Seil (1), bis der Entriegelungshebel (2) senkrecht steht.

Verriegelung

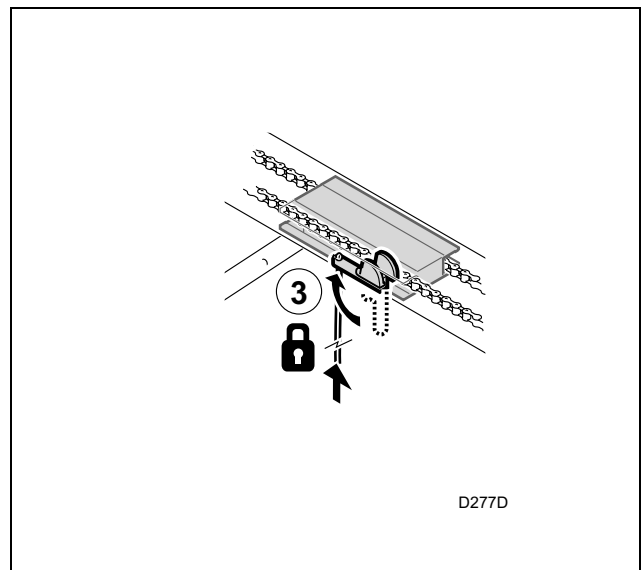

Verriegelung für motorischen Antrieb

Legen Sie den Hebel in waagerechte Position (3). Die Verriegelung erfolgt bei funktionierendem Antrieb.

Montage

1 Schiene (1) am Antrieb (2) befestigen.

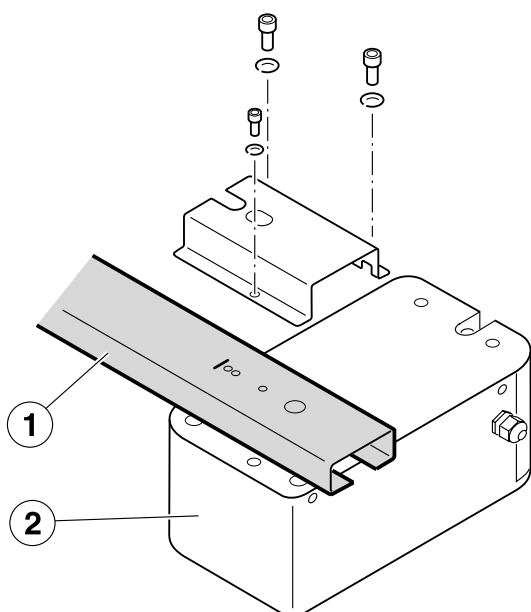

2 Deckenpletinen (3) und vordere Halterung (4) anbringen. Montagemaß H beachten (siehe "Montagemaße" auf der vorangehenden Seite).

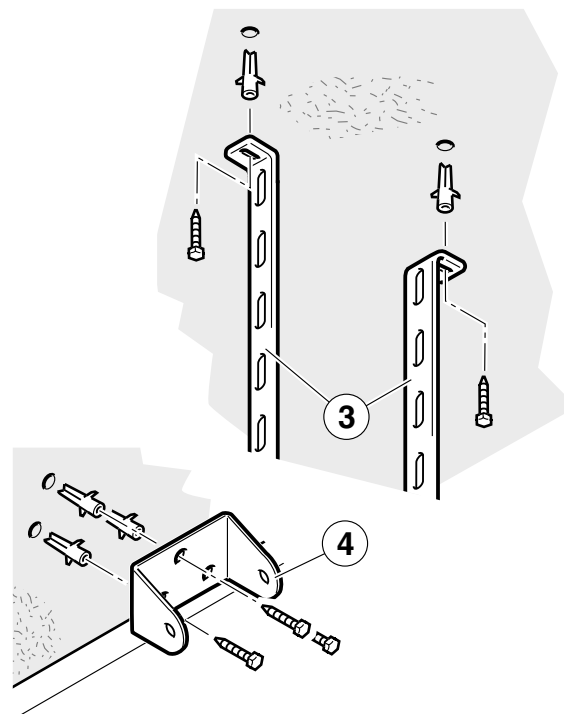

3 Schiene (1) + Antrieb (2) an den Halterungen (3) und (4) anbringen.

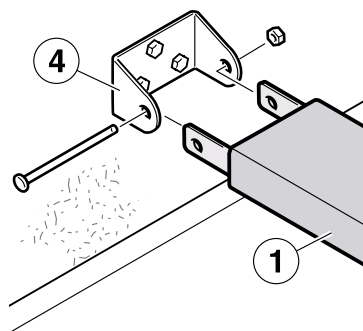

1 Die Schiene (1) muss waagrecht liegen.

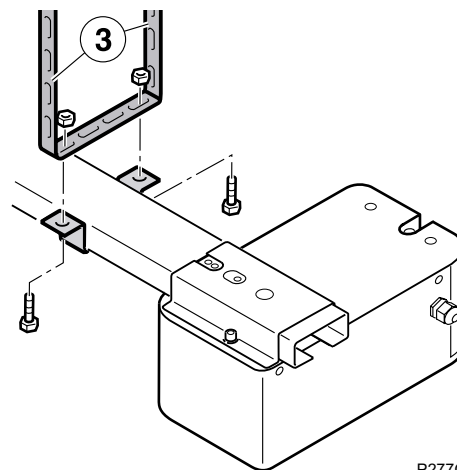
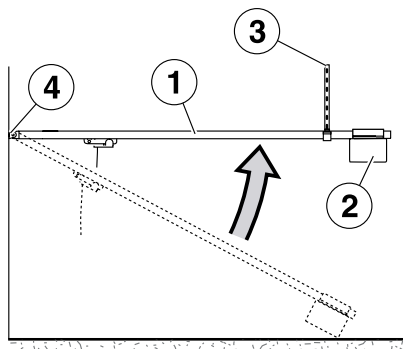

P277C

4 Verankerung (5) an der Oberseite des Tors anbringen und anhand der Arme (6) und (7) am Wagen (8) einhängen.

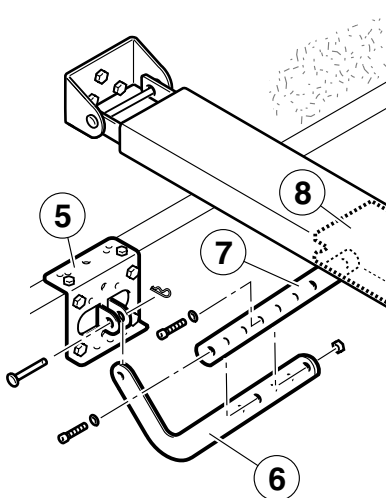
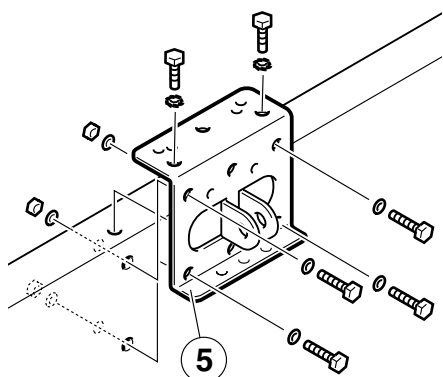

P260D

5 Kette spannen: Mutter bis zum Anschlag anziehen und danach etwas lockern, bis die Hülse per Hand gedreht werden kann.

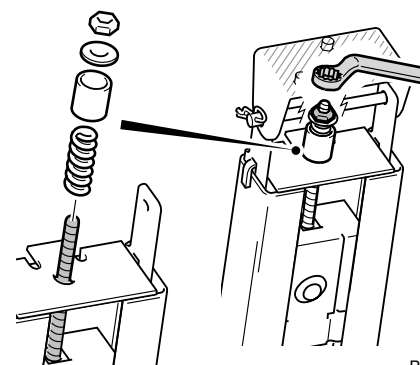

P260E

6 Die zentrale Halterung (9) anbringen.

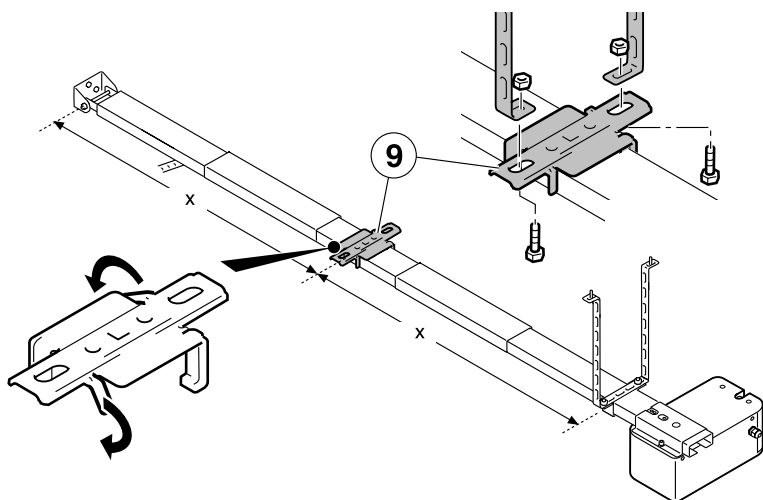

P277F

7 Tor öffnen und Öffnungsanschlag (10) so anbringen, dass er am Wagen (11) anschlägt. Zwei selbstbohrende und gewindeformende Schrauben verwenden.

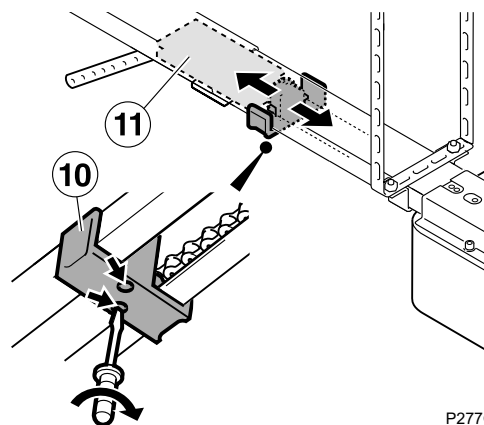

P277G

Elektrische Anschlüsse (Steuerung VIVO-D102)

⚠ Stromversorgung vor dem Ein- oder Ausschalten von Komponenten abschalten.

- Die Vorrichtungen A.T., SG.C und SG.A müssen zur Vermeidung von Schäden an der Steuerung potentialfrei sein.

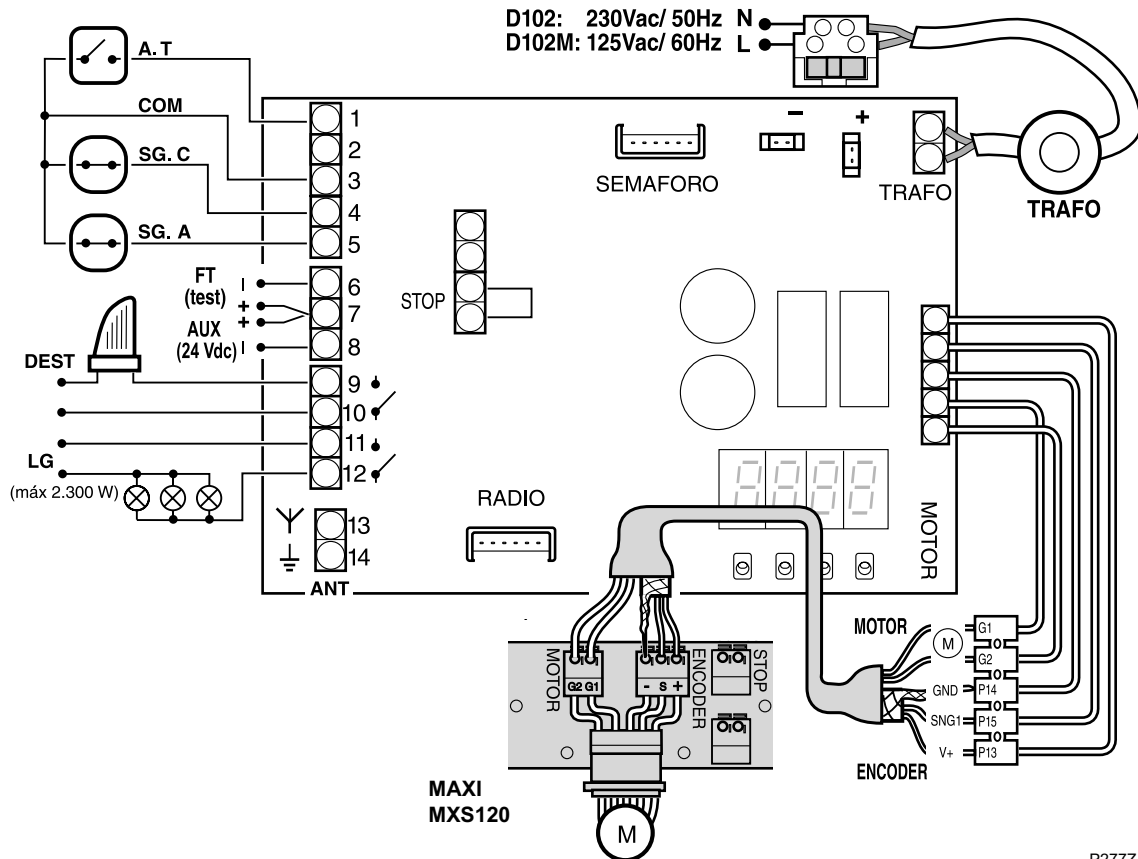

P277Z

- A.T. Drucktaster/ Schlüsseltaster
- SG.C Sicherheitsvorrichtung beim Schließen (Lichtschanke Schließen)
- SG.A Sicherheitsvorrichtung beim Öffnen (Lichtschanke Öffnen)
- FT Anschluss für Lichtschanke mit Testfunktion
- AUX Stromversorgung von Peripheriegeräten (24 VDC)
- STOP Wird nicht verwendet, überbrücken
- DEST Blinklampe (LUMI)
- LG Garagenlichter

- G1 Blau (Motor)
- G2 Rot (Motor)
- P14 (GND) Netz (Encodermasse) (-)
- P15 (SNG1) Grün (Encodersignal) (S)
- P13 (V+) Braun (Stromversorgung Encoder) (+)